



## Schaumburg Convention Center Ancillary Meeting Room Request

AUTOTESTCON 2013 will accommodate your company or organization's "ancillary" meetings at the Schaumburg Convention Center on a first-come, first-served basis. Ample ancillary room availability is expected, but cannot be guaranteed, so reserve your rooms soon. Meeting room fees at the Schaumburg Convention Center are \$200.00 per day (pro-rated for shorter blocks of time). Arrange your own A/V & Food/Beverage service through the Point of Contact listed below. Room set-up charges will vary (and may be free). Rooms are available from Sunday, September 15 through Thursday, September 19.

For meeting or hospitality room arrangements at the Renaissance Schaumburg Convention Center Hotel, contact Katie Flodin at (847) 303-4186 or [katherine.flodin@renaissancehotels.com](mailto:katherine.flodin@renaissancehotels.com).

**Both the Convention Center and the Renaissance** can accommodate breakfast meetings, after-hours meetings, private receptions, technical workshops, and other activities. Full catering menus are available from which to choose, as well as a variety of set-ups for your meeting.

Rooms may be available to accommodate up to several hundred people (a special evening reception, for example).

**Requested Day-Date:** \_\_\_\_\_ **Times:** \_\_\_\_\_

**Company/Organization:** \_\_\_\_\_

**Address:** \_\_\_\_\_  
 Street address or PO Box, City, State, Zip

**Contact: Name** \_\_\_\_\_ **Phone** \_\_\_\_\_

**E-mail:** \_\_\_\_\_

**Credit card for room charge:** \_\_\_\_\_ **Exp** \_\_\_\_ / \_\_\_\_

**Type of card:** MC \_\_\_ VISA \_\_\_ AmEx \_\_\_ **Name on card:** \_\_\_\_\_

**Type of function:** \_\_\_\_\_  
 Sales meeting, customer reception, etc

**Number of people:** \_\_\_\_\_ **Room set-up:** \_\_\_\_\_  
 (Conference, Theatre, Classroom, Reception)

**To arrange required Audio-Visual equipment, refreshments/food service,** contact Katie Flodin at (847) 303-4186 or [katherine.flodin@renaissancehotels.com](mailto:katherine.flodin@renaissancehotels.com).

If multiple meetings are needed, please use a separate form for each day & time.

Send this form to Lisa Pollock at [lisa.pollock@ngc.com](mailto:lisa.pollock@ngc.com), fax to: 224-625-3021, or mail to 600 Hicks Road, Rolling Meadows, IL 60008.

For inquiries, contact Vicky Bekeleski 224-625-6611 or [vicky.bekeleski@ngc.com](mailto:vicky.bekeleski@ngc.com).



**RENAISSANCE<sup>®</sup>**  
**SCHAUMBURG**  
**HOTEL & CONVENTION CENTER**



## Capacities

Convention Center Meeting Rooms	Dimensions (WxLxH)	Square Footage	Theater	Schoolroom	Conference	U-Shape	Reception	Banquet	Booths (10x10)
Convention Center	270x360x30	97,200	6,300	4,800	—	—	6,300	5,100	459
Exploration Hall	270x119x30	32,130	2,100	1,600	—	—	2,100	1,700	150
Discovery Hall	270x120x30	32,400	2,100	1,600	—	—	2,100	1,750	162
Adventure Hall	270x121x30	32,670	2,100	1,600	—	—	2,100	1,700	151
Exploration - Discovery	270x239x30	64,530	4,387	1,930	—	—	3,270	3,075	241
Adventure - Discovery	270x241x30	65,070	4,387	1,946	—	—	3,300	3,075	243
Show Offices (io)*	13x12x11	156	—	—	—	—	—	—	—
Convention Center Pre-function Area	—	19,000	—	—	—	—	3,000	—	—

### Hotel Meeting Rooms

	Dimensions (WxLxH)	Square Footage	Theater	Schoolroom	Conference	U-Shape	Reception	Banquet	Booths (8x10)
Schaumburg Ballroom	130x208x22	27,502	2,400	1,080	—	—	3,800	1,700	144
Schaumburg Foyer West	20x158x11	3,621	—	—	—	—	517	—	—
Schaumburg Foyer North	39x211x11	8,178	—	—	—	—	1,168	—	—
Schaumburg West & East	130x140x22	17,680	1,700	900	—	—	2,500	1,200	106
Schaumburg West	130x68x22	8,840	800	450	—	—	1,250	600	50
Schaumburg East	130x68x22	8,840	800	450	—	—	1,250	600	50
Schaumburg A	34x34x22	1,156	100	60	28	32	150	80	6
Schaumburg B	34x34x22	1,088	100	60	28	32	150	80	6
Schaumburg C	34x34x22	1,088	100	60	28	32	150	80	6
Schaumburg D	34x34x22	1,156	100	60	28	32	150	80	6
Schaumburg E	34x34x22	1,156	100	60	28	32	150	80	6
Schaumburg F	34x34x22	1,088	100	60	28	32	150	80	6
Schaumburg G	34x34x22	1,088	100	60	28	32	150	80	6
Schaumburg H	34x34x22	1,156	100	60	28	32	150	80	6
Utopia Ballroom	59x119x15	7,021	760	420	—	—	900	480	38
Utopia A	59x30x15	1,770	190	100	46	47	225	120	10
Utopia B	59x30x15	1,770	190	100	46	47	225	120	10
Utopia C	59x30x15	1,770	190	100	46	47	225	120	10
Utopia D	59x30x15	1,770	190	100	46	47	225	120	10
Utopia Threshold	28x75x15	2,100	—	—	—	—	550	—	—
Euphoria	59x30x15	1,770	190	100	46	47	225	120	10
Nirvana Ballroom	59x90x15	5,310	570	320	—	—	750	360	28
Nirvana A	59x30x15	1,770	190	100	46	47	225	120	10
Nirvana B	59x30x15	1,770	190	100	46	47	225	120	10
Nirvana C	59x30x15	1,770	190	100	46	47	225	120	10
Nirvana Threshold	28x60x15	1,680	—	—	—	—	400	—	—
Perfection Parlor	26x17x10	442	—	—	—	—	20	—	—
Perfection Boardroom	26x23x10	598	—	—	12	—	—	—	—
Knowledge	39x20x10	780	64	28	34	29	100	60	—
Connection	42x20x10	840	65	36	34	29	100	60	—
Imagination	41x20x10	820	70	36	34	29	100	60	—
Innovation	40x20x10	800	64	28	34	29	100	60	—
Epiphany	19x29x10	551	48	24	24	21	60	40	—
Prosperity	19x30x10	570	48	30	24	21	60	40	—
Serenity	18x23x10	414	32	24	16	15	50	24	—
Journey*	21x15x11	315	—	—	10	—	—	—	—
Creation*	21x12x11	252	—	—	8	—	—	—	—

\* Not shown — located near Convention Center.

# Floor Plans

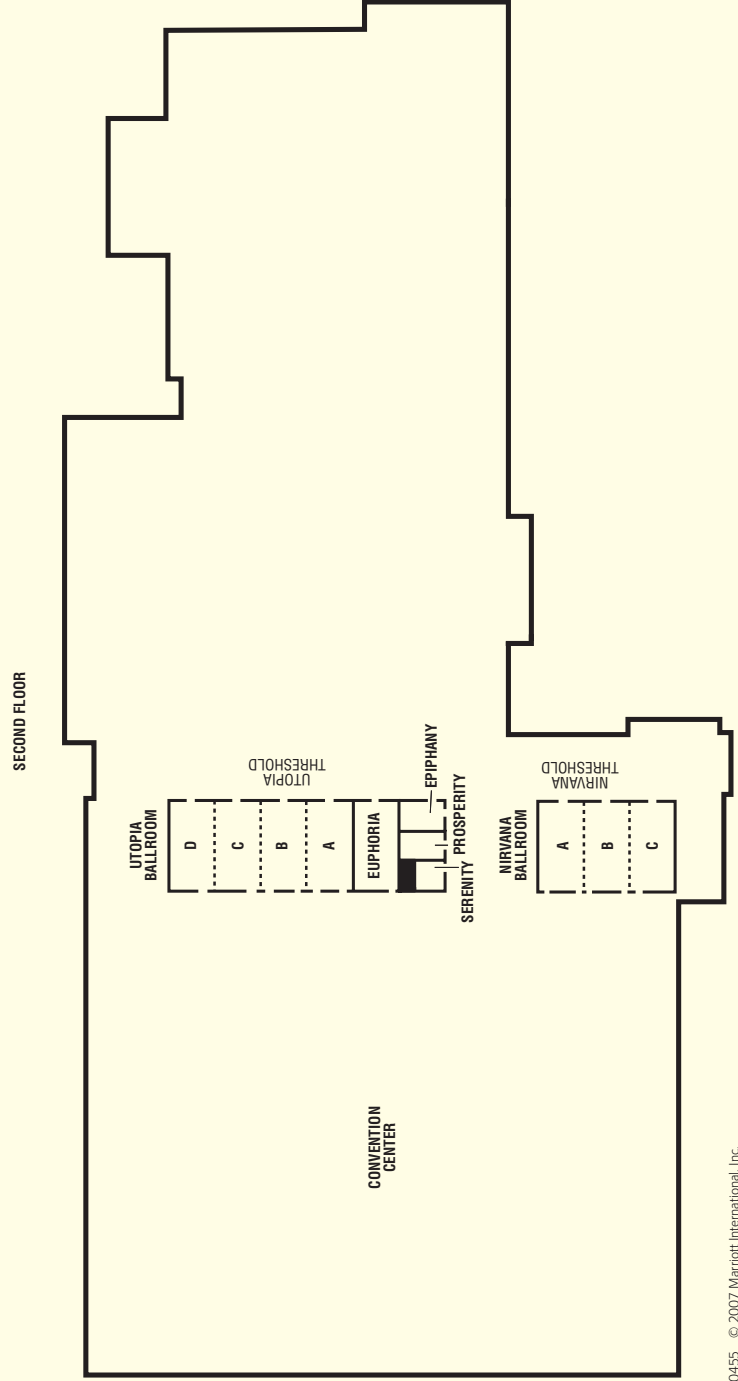
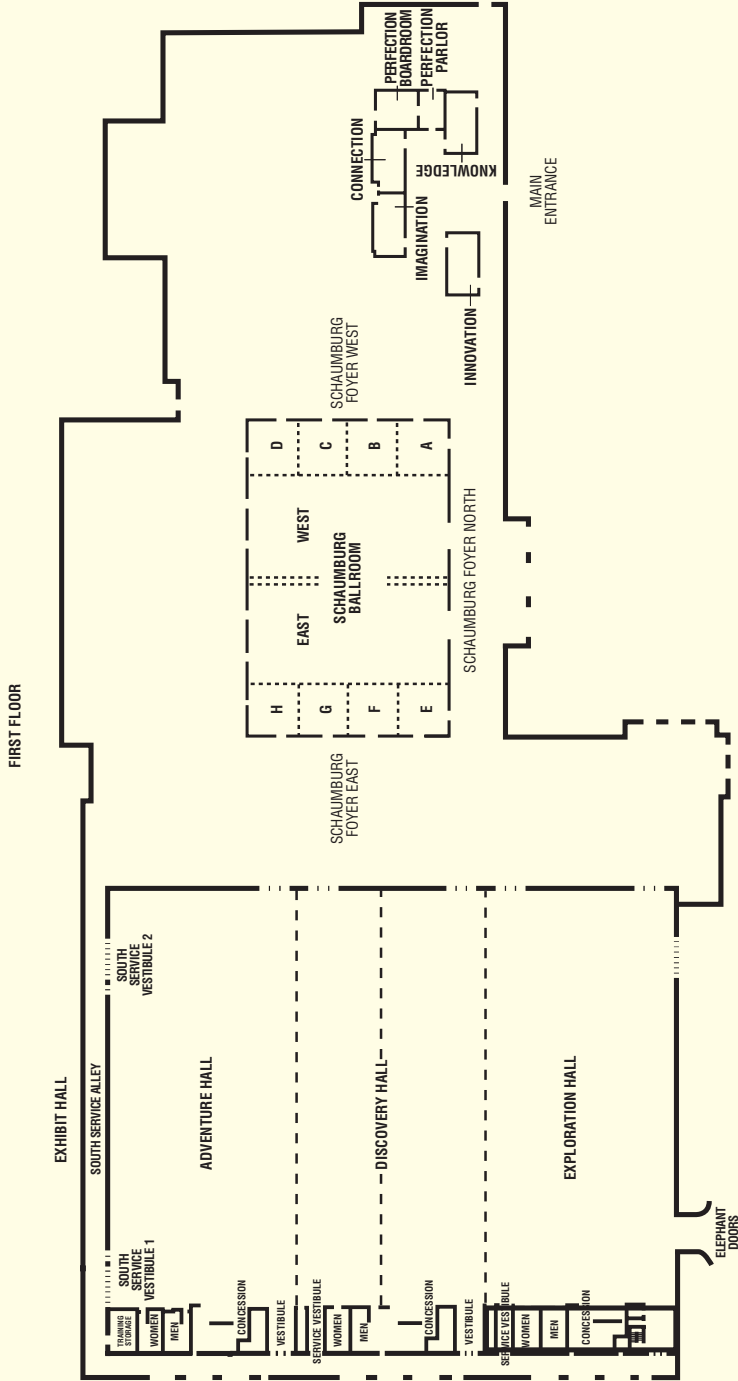

## RENAISSANCE SCHAUMBURG HOTEL & CONVENTION CENTER

1551 N. THOREAU DRIVE • SCHAUMBURG, ILLINOIS 60173

PHONE: 847-303-4100 FAX: 847-303-4199

RENAISSANCESCHAUMBURG.COM 1-800-HOTELS-1